



# SERIES ASM

## NEOPRENE/EPMD FLANGED SINGLE SPHERE CONNECTOR

Pressures to 225 PSIG (15.51 barg)  
Temperatures to 230°F (110°C)

### APPLICATIONS

- Process Industry
- Oil & Gas
- Weak Acids
- Water & Waste
- Alkalies
- Pump suction & discharge
- Compressed Air
- Sea water
- Pulp & Paper
- Chemical lines

### MODELS

- ASM - Flanged Connection

### OPTIONS

- Control Rods

- For connection pipes and equipment where flanged ends are preferred
- Flat faced flanged single sphere connectors
- Easy to install floating flanges allow variable pressure, temperature and movement
- Increased acoustic resistance, dampens hydraulic surge and shock
- Accommodates thermal movement and misalignment
- Four way greater movement provides high level of installation flexibility
- Precision molded synthetic rubber reinforced with nylon cord
- Horizontal or vertical mounting

### PRESSURE/TEMPERATURE RATINGS

WITHOUT CONTROL RODS

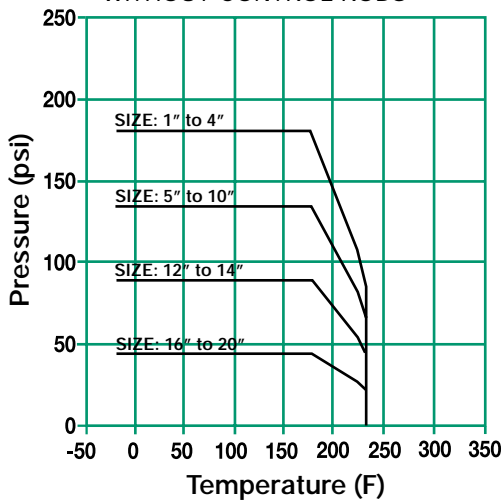

### PRESSURE/TEMPERATURE RATINGS

WITH CONTROL RODS

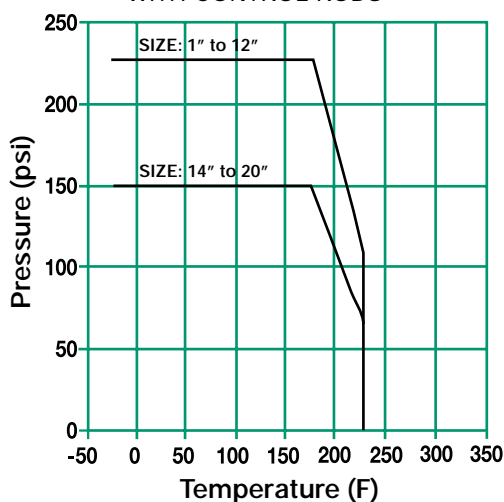

### Series ASM Ordering Code

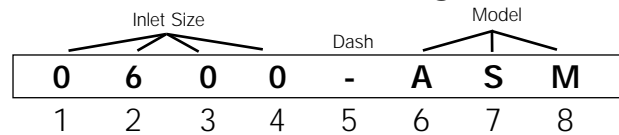

#### Inlet Size\* - Position 1 - 4

0100 - 1"	0600 - 6"
0125 - 1¼"	0800 - 8"
0150 - 1½"	1000 - 10"
0200 - 2"	1200 - 12"
0250 - 2½"	1400 - 14"
0300 - 3"	1600 - 16"
0400 - 4"	1800 - 18"
0500 - 5"	2000 - 20"

#### Dash - Position 5

**Model** - Position 6 -8  
ASM - Single Sphere,  
FLG, CI, Neoprene

### Part Numbers for Ordering Single Sphere Connector Control Rods

ASM	
Size	Part Number
1	0100-ASMROD
1¼	0125-ASMROD
1½	0150-ASMROD
2	0200-ASMROD
2½	0250-ASMROD
3	0300-ASMROD
4	0400-ASMROD
5	0500-ASMROD
6	0600-ASMROD
8	0800-ASMROD
10	1000-ASMROD
12	1200-ASMROD
14	1400-ASMROD
16	1600-ASMROD
18	1800-ASMROD
20	2000-ASMROD

Other sizes available. Consult factory.

# SERIES ASM

## NEOPRENE/EPMD FLANGED SINGLE SPHERE CONNECTOR

### SPECIFICATION

Single Sphere Connector body material shall be neoprene cover and tube elastomer with nylon cord fabric reinforcement. The single sphere connector will have Carbon Steel, Zinc Plated flanges and a hard steel wire frame. The twin sphere connector shall be SSI ASM Series.

### MATERIALS OF CONSTRUCTION

Body .....Neoprene  
Reinforcing Fabric .....Nylon Cord Fabric  
Wire .....Hard Steel Wire  
Floating Flanges .....Carbon Steel Zinc Plated RST 37-2

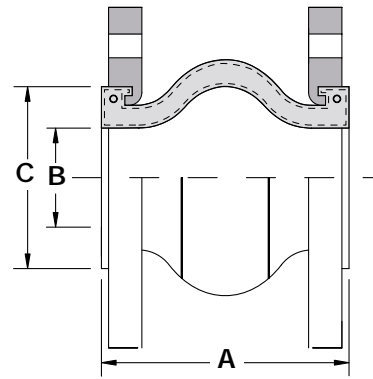

Connections: 1" to 20" Flanged

Burst Pressure 850 PSIG

### DIMENSIONS inches (mm) AND WEIGHTS pounds (kg)

Size	A	Allowable Movement				B	C	Weight	
		Axial Compression	Axial Extension	Lateral Deflection	Angular Deflection			Connector Only	With Rods
1 (25)	6 (152)	3/4 (19)	15/32 (12)	9/16 (14)	19/32 (15)	1 <sup>11</sup> / <sub>32</sub> (39)	2 <sup>5</sup> / <sub>16</sub> (75)	5 (2.3)	10 (4.7)
1 <sup>1</sup> / <sub>4</sub> (32)	6 (152)	3/4 (19)	15/32 (12)	9/16 (14)	19/32 (15)	1 <sup>11</sup> / <sub>32</sub> (39)	2 <sup>5</sup> / <sub>16</sub> (75)	7 (3.2)	10 (4.7)
1 <sup>1</sup> / <sub>2</sub> (38)	6 (152)	3/4 (19)	15/32 (12)	9/16 (14)	19/32 (15)	1 <sup>11</sup> / <sub>32</sub> (39)	2 <sup>5</sup> / <sub>16</sub> (75)	8 (3.6)	12 (5.4)
2 (51)	6 (152)	3/4 (19)	15/32 (12)	9/16 (14)	19/32 (15)	1 <sup>29</sup> / <sub>32</sub> (48)	3 <sup>5</sup> / <sub>16</sub> (86)	11 (5.0)	15 (7.0)
2 <sup>1</sup> / <sub>2</sub> (64)	6 (152)	3/4 (19)	15/32 (12)	9/16 (14)	19/32 (15)	2 <sup>15</sup> / <sub>32</sub> (63)	4 <sup>5</sup> / <sub>16</sub> (105)	11 (5.0)	19 (8.7)
3 (76)	6 (152)	3/4 (19)	15/32 (12)	9/16 (14)	19/32 (15)	2 <sup>7</sup> / <sub>16</sub> (73)	4 <sup>21</sup> / <sub>32</sub> (118)	13 (5.9)	23 (10.4)
4 (102)	6 <sup>1</sup> / <sub>8</sub> (156)	3/4 (19)	15/32 (12)	9/16 (14)	19/32 (15)	3 <sup>15</sup> / <sub>16</sub> (100)	5 <sup>27</sup> / <sub>32</sub> (148)	17 (7.7)	25 (11.4)
5 (127)	6 <sup>1</sup> / <sub>8</sub> (156)	3/4 (19)	15/32 (12)	9/16 (14)	19/32 (15)	5 (127)	7 <sup>1</sup> / <sub>16</sub> (178)	21 (9.5)	30 (13.6)
6 (152)	6 <sup>1</sup> / <sub>8</sub> (156)	3/4 (19)	15/32 (12)	9/16 (14)	19/32 (15)	5 <sup>25</sup> / <sub>32</sub> (147)	8 <sup>3</sup> / <sub>16</sub> (210)	25 (11.3)	37 (16.8)
8 (203)	6 <sup>1</sup> / <sub>8</sub> (156)	1 (25)	15/32 (12)	7/8 (22)	19/32 (15)	7 <sup>27</sup> / <sub>32</sub> (199)	10 <sup>1</sup> / <sub>4</sub> (260)	37 (16.8)	53 (24.0)
10 (254)	8 (203)	1 (25)	5/8 (16)	7/8 (22)	19/32 (15)	9 <sup>3</sup> / <sub>4</sub> (248)	12 <sup>11</sup> / <sub>16</sub> (322)	58 (26.3)	82 (37.2)
12 (305)	8 (203)	1 (25)	5/8 (16)	7/8 (22)	19/32 (15)	11 <sup>27</sup> / <sub>32</sub> (296)	14 <sup>5</sup> / <sub>16</sub> (370)	80 (36.3)	109 (49.4)
14 (356)	8 (203)	1 (25)	5/8 (16)	7/8 (22)	19/32 (15)	13 <sup>7</sup> / <sub>32</sub> (336)	16 <sup>1</sup> / <sub>4</sub> (413)	101 (45.8)	138 (62.6)
16 (406)	8 (203)	1 (25)	5/8 (16)	7/8 (22)	19/32 (15)	15 <sup>5</sup> / <sub>32</sub> (385)	18 <sup>3</sup> / <sub>32</sub> (464)	127 (57.6)	176 (79.8)
18 (457)	8 (203)	1 (25)	5/8 (16)	7/8 (22)	19/32 (15)	17 <sup>7</sup> / <sub>16</sub> (440)	20 <sup>5</sup> / <sub>16</sub> (524)	136 (61.7)	183 (83.0)
20 (508)	8 (203)	1 (25)	5/8 (16)	7/8 (22)	19/32 (15)	19 <sup>9</sup> / <sub>32</sub> (490)	22 <sup>5</sup> / <sub>16</sub> (573)	158 (71.7)	212 (96.1)

Other sizes available. Consult factory.

Dimensions are subject to change. Consult factory for certified drawings when required.

#### Installation Note:

For correct Installation & Maintenance instructions see page 244