

300WT SERIES CAST STEEL AND STAINLESS STEEL DOUBLE DOOR CHECK VALVES

PRESSURES TO 740 PSIG (51 BARG)
TEMPERATURES TO 600°F (316°C)

APPLICATIONS

- Liquid and Air Service
- Process Industry
- Power Industry
- Chemical Industry
- Oil & Gas
- Pulp & Paper
- Metal & Mining
- Water & Waste

- ASME Class 300 rated check valves
- Wafer body style fits between FF or RF flanges
- Size 6" and larger are supplied with a valve lifting lug
- Upper and lower SS thrust washers
- Resilient Buna-N and Viton
- Seat design lifts then swings discs to minimize seat wear
- Shock bumpers minimize stresses in hinge pins
- Independent springs optimizes valve plate closing rates while minimizing spring stress
- Dual ratings 2"-3" 150#, 300# and 600#.
- Dual ratings 4" 150# and 300#.

PRESSURE/TEMPERATURE CHART

ASME B16.34

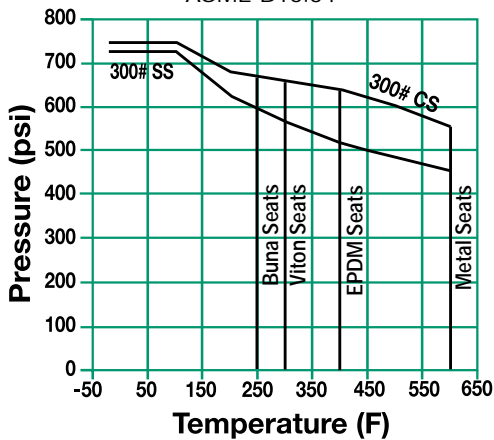

Contact factory for EPDM pressure/temperature range.

MODELS

- 300WTCT – Cast Steel Body, Stainless Steel Disc, Buna Seat
- 300WTTT – Stainless Steel Body, Stainless Steel Disc, Viton Seat

OPTIONS (CONSULT FACTORY)

- EPDM Seats
- Other Spring Material

APPLICABLE CODES

- ASME B16.34 ratings
- API 594
- API 598

Canadian Registration - OC10274.5C

300WT Series Ordering Code

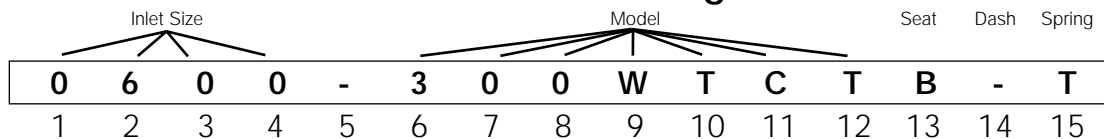

Inlet Size* - Position 1 - 4
2", 2½", 3" sizes use 600WT Series
0400 - 4"
0600 - 6"
0800 - 8"
1000 - 10"
1200 - 12"

Dash - Position 5

Model - Position 6 - 12
300WTCT - CS Body
300WTTT - SS Body

Seat* - Position 13
B - Buna-N (CS Body only)
V - Viton (SS Body only)

Dash - Position 14

Spring - Position 15
T - SS

*300WTCT - Buna-N seat only
300WTTT - Viton seat only

300WT SERIES CAST STEEL AND STAINLESS STEEL DOUBLE DOOR CHECK VALVES

SPECIFICATION

Check Valve shall be dual disc design with Cast Steel or Stainless Steel Body wafer body style designed to ASME B16.34 ratings and API 594. The check valve shall have an integral cast bumper and Buna-N or Viton resilient seats with SS discs. The check valve shall be ASME Class 300 rated. The spring shall be 316SS. The seat design shall lift then swing discs to minimize seat wear. The check valve shall be SSI 300WT Series..

MATERIALS OF CONSTRUCTION

| Part | Carbon Steel | Stainless Steel |
|--------|--------------|-----------------|
| Body | A216-WCB | A351-CF8M |
| Discs | A351-CF8M | A351-CF8M |
| Seat | Buna-N | Viton |
| Spring | 304 SS | 304 SS |

CRACKING PRESSURE

Horizontal Mounting - .3psid

Vertical Mounting - .75 to 1.25 psid

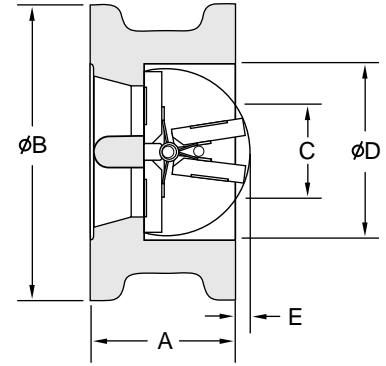
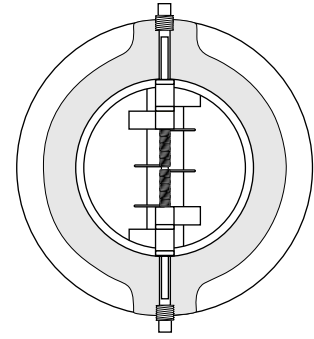

DOUBLE DOOR
CHECK VALVES

DIMENSIONS inches (mm) AND WEIGHTS pounds (kg)

| Size | A ¹ | B [*] | C ² | D | E | STUD SELECTION | | | Weight | |
|-------------------------|--------------------------------|----------------|----------------|--------------|--------------|----------------|------|-------------|--------------|---------------|
| | | | | | | Qty. | Dia. | Length | | |
| 2 ³ (50) | Use 2" 600WT 300# on page 191 | | | | | | | | | |
| 2½ ³ (66) | Use 2½" 600WT 300# on page 191 | | | | | | | | | |
| 3 ³ (80) | Use 3" 600WT 300# on page 191 | | | | | | | | | |
| 4 ⁴ (100) | 150WT | 2½ (73) | 6½ (175) | 3½ (86) | 4½ (114) | ¾ (19) | 8 | 5/8 (16) | 7 (178) | 18 (8.2) |
| | 300WT | 2½ (73) | 7½ (181) | 3½ (86) | 4½ (114) | ¾ (19) | 8 | ¾ (19) | 8½ (207) | 18 (8.2) |
| 6 (150) | | 3½ (99) | 9½ (251) | 5½ (137) | 6½ (168) | 1½ (35) | 12 | ¾ (19) | 9½ (245) | 44 (20.0) |
| 8 (200) | | 5 (127) | 12½ (308) | 7½ (187) | 8½ (219) | 2 (51) | 12 | 7/8 (22) | 11¼ (286) | 75 (34.0) |
| 10 (250) | | 5½ (146) | 14¼ (362) | 9½ (241) | 10¼ (273) | 2½ (73) | 16 | 1 (25) | 12¾ (324) | 123 (55.8) |
| 12 (300) | | 7½ (181) | 16½ (422) | 11¼ (286) | 12¾ (324) | 3½ (86) | 16 | 1½ (29) | 14½ (372) | 196 (89.0) |

Connections: 4" to 12"
Wafer Flanged

Seats:
CS Body - 4" to 12" Buna-N
SS Body - 4" to 12" Viton

1. Dimensions in accordance with API 594.
2. Minimum bore diameter of companion flanges.
3. Sizes 2", 2½" & 3" for 150WT, 300WT & 600WT are interchangeable, use 600WT for all applications in these sizes.
4. Size 4" for 150WT & 300WT are interchangeable, use 300WT for 4" size. 4" sizes fit between both 150# & 300# flanges.

* Add the "B" dimension and the diameter of the stud to achieve the ANSI B16.5 bolt hole circle diameter.

300WT SERIES DOUBLE DOOR CHECK VALVES

CAST STEEL AND STAINLESS STEEL

PRESSURE DROP - LIQUIDS

Sizes 4" - 12"

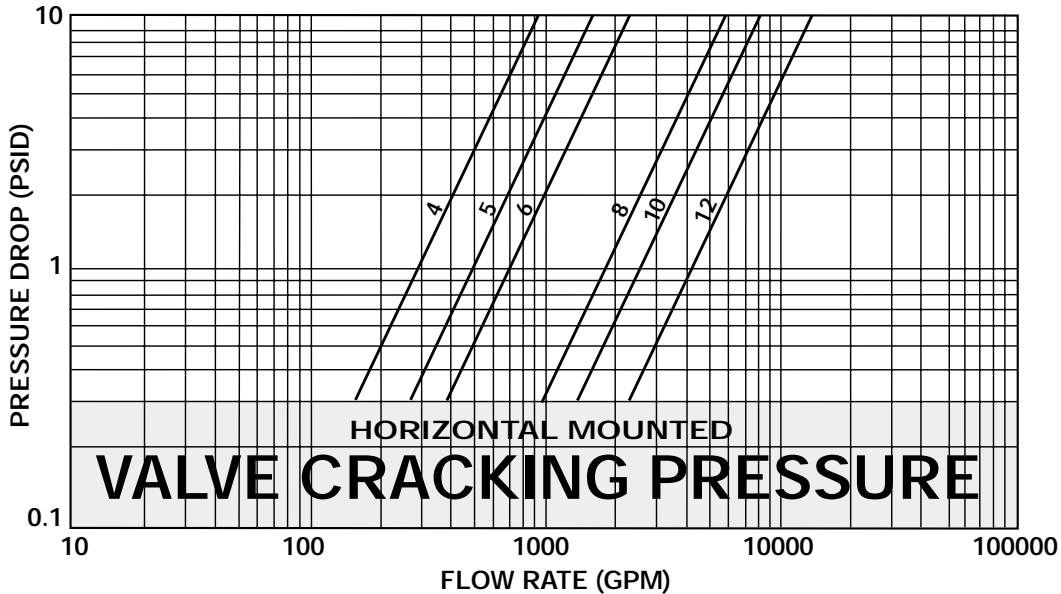

- (1) Pressure drop curves are based on water flow.
- (2) Valve cracking pressure is equal to or less than 0.3 psid when mounted horizontally.
- (3) Valve cracking pressure increases to between 0.75 and 1.25 psid when installed vertically with flow upwards.

PRESSURE DROP - AIR

Sizes 4" - 12"

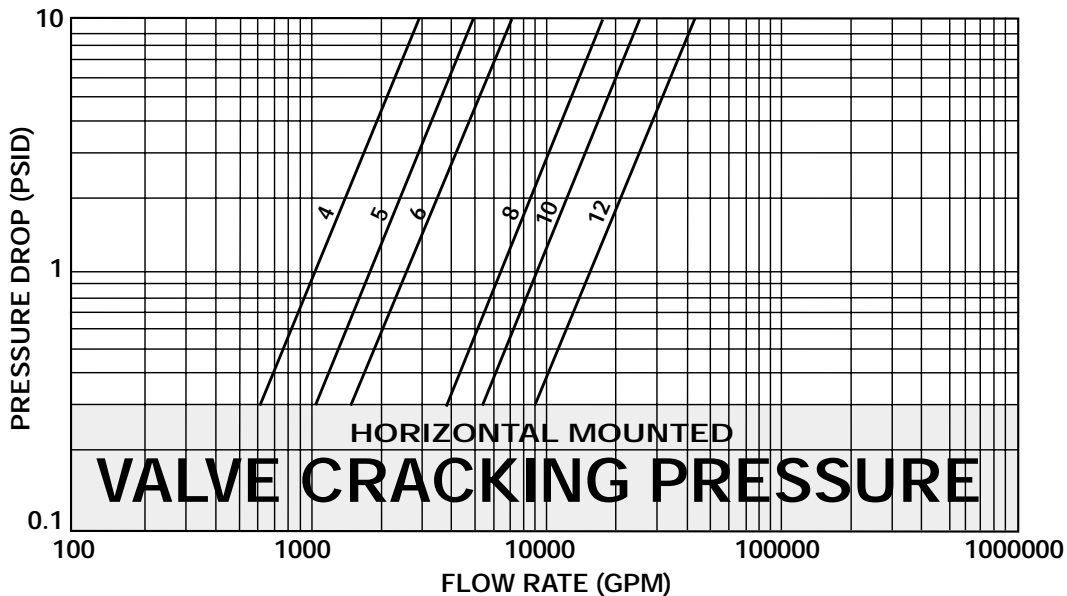

- (1) Pressure drop curves are based on air flow at 60 OF and 1 ATM pressure.
- (2) Valve cracking pressure is equal to or less than 0.3 psid when mounted horizontally.
- (3) Valve cracking pressure increases to between 0.75 and 1.25 psid when installed vertically with flow upwards.

Installation Note:

- 1) For correct installation and maintenance please see our I&M manual.
- 2) Horizontal installation – Disc pin must be installed in vertical position.
- 3) Vertical installation (downward flow) – Consult factory.

C_v VALUES (US-GPM @ 1 PSID)

| Valve Size (inches) | 4 | 5 | 6 | 8 | 10 | 12 |
|---------------------|-----|-----|-----|------|------|------|
| C _v | 291 | 494 | 705 | 1795 | 2563 | 4295 |

