

# Solid State Relay

**TA600** Series • AC Output

CONTROLLER ACCESSORIES



TA625 shown

The Trerice **TA600 Series** Solid State Relay has no moving parts, rendering it impervious to shock and vibration, and giving it a virtually infinite life.

## HOW TO ORDER

Please order using Item Number **TA610** , **TA625** or **TA640**

All dimensions are nominal. Dimensions in [ ] are in millimeters.

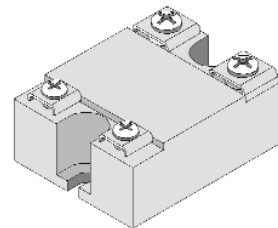
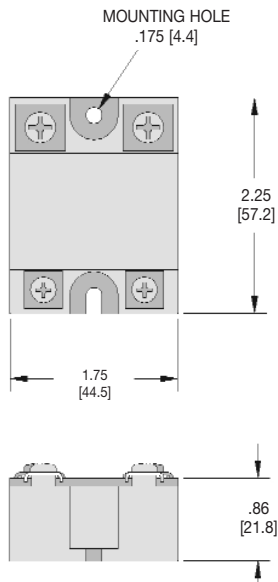

## Specifications

### Models

**TA610:** 10 A output  
**TA625:** 25 A output  
**TA640:** 40 A output

**Case** Epoxy molded with aluminum baseplate

**Connection** Screw terminals

**Input** Voltage: 3-32 VDC  
 Impedance: 1000Ω minimum  
 Must turn on: 3.0 VDC  
 Must turn off: 1.0 VDC  
 Isolation signal to load: 7000 VDC  
 Isolation signal to base: 2500 VDC  
 Capacitance signal to load: 15 pt

**Output** Voltage: 20~300 Vrms  
 Typical turn-on voltage: 5 Vrms  
 Response time: 0.5 cycle max.  
 OFF state DV/DT: 200 V/m sec  
 OFF state leakage current: 15 mA  
 Max. non-repetitive single cycle surge current: 400 A  
 Cycle surge current: 400 A  
 IT for fusing (T=8.3 ms): 400 AS  
 Peak inverse voltage: 600 Vpk

### Ambient Temperature

-20°F (-30°C) to 140°F (60°C)

### Approximate Shipping Weight

0.2 lbs [0.09 kg]